

Management system as per

ISO 9001: 2015
ISO 14001: 2015



Website



LinkedIn

ENGEL MACHINERY (CHANGZHOU) CO., LTD.
No. 9 Longfan Road, Wujin National Hi-Tech Industrial Zone,
Changzhou 213166, Jiangsu Province, P.R. China
tel: +86 519 8159 5300
e-mail: info@wintec-machines.com

ENGEL AUSTRIA GmbH
Ludwig-Engel-Straße 1
4311 Schwertberg
Austria
tel.: +43 50 620 0
e-mail: info@wintec-machines.com

2025-12_EN

WINTEC
MEMBER OF THE ENGEL GROUP

t-win

HYDRAULIC TWO PLATEN INJECTION MOLDING MACHINE



www.wintec-machines.com

Production Locations



As a member of the ENGEL Group, WINTEC was established in China in 2014. We are committed to providing customers with high-performing, efficient, cost-effective injection molding machines and solutions. We shatter the impossible trio of quality, efficiency and cost, being your reliable partner for your successful international development.

ENGEL GROUP

12 PRODUCTION PLANTS

39 SUBSIDIARIES

21 REPRESENTATIVES





We at WINTeC make proven innovations accessible and bring them straightforward, hassle-free and deliver you the streamlined injection molding solutions. Leveraging ENGEL's 80 years of engineering excellence and sharing its global sales and service network, we turn industry-leading performance into your tangible competitive edge.

After years of growth and continuous development of our portfolio, WINTeC brings you the smartest path to your long-term success: Plug & Inject.

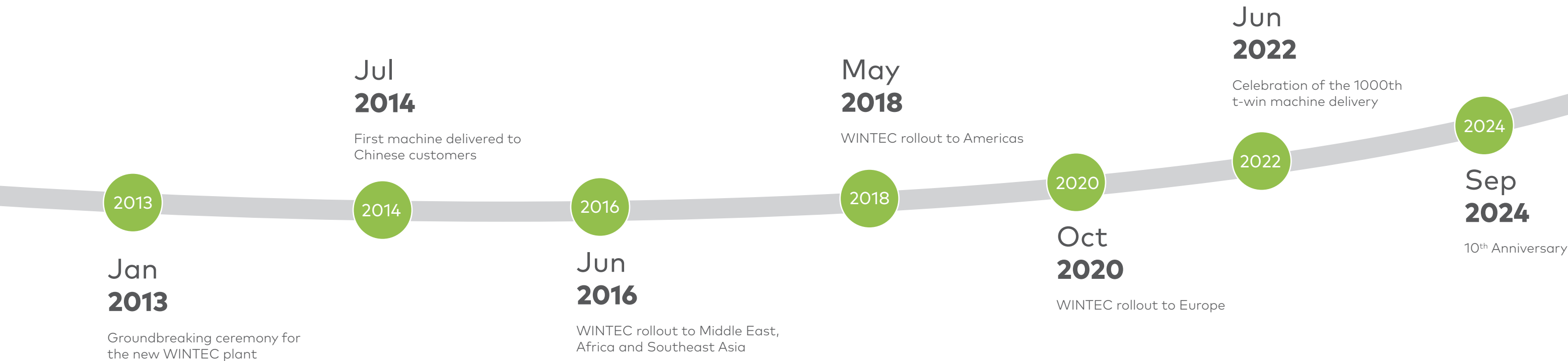

t-win

YOUR ADVANTAGES AT A GLANCE

HIGHER PRODUCTIVITY

The servo hydraulic two-platen t-win is focused on fast and high efficient production. Fast movements, short clamping force build-up time and synchronized locking device movement reduce total cycle time and increase productivity.

INCREASED AVAILABILITY

The reliable and proven design as well as features allow fast access for maintenance and increase machine availability and output.

HIGHER ENERGY EFFICIENCY

The servo drive system servowin guarantees fast acceleration and low energy consumption.



SMALLER FOOTPRINT

The two-platen machine concept allows a compact design for less space requirements.

SMARTER CONTROL UNIT

Future-oriented technologies with long-term availability and transformation. Powerful extending function for future challenges. C3 controller keeps you on top of processes that continue to become more and more complex.

Smart Machine

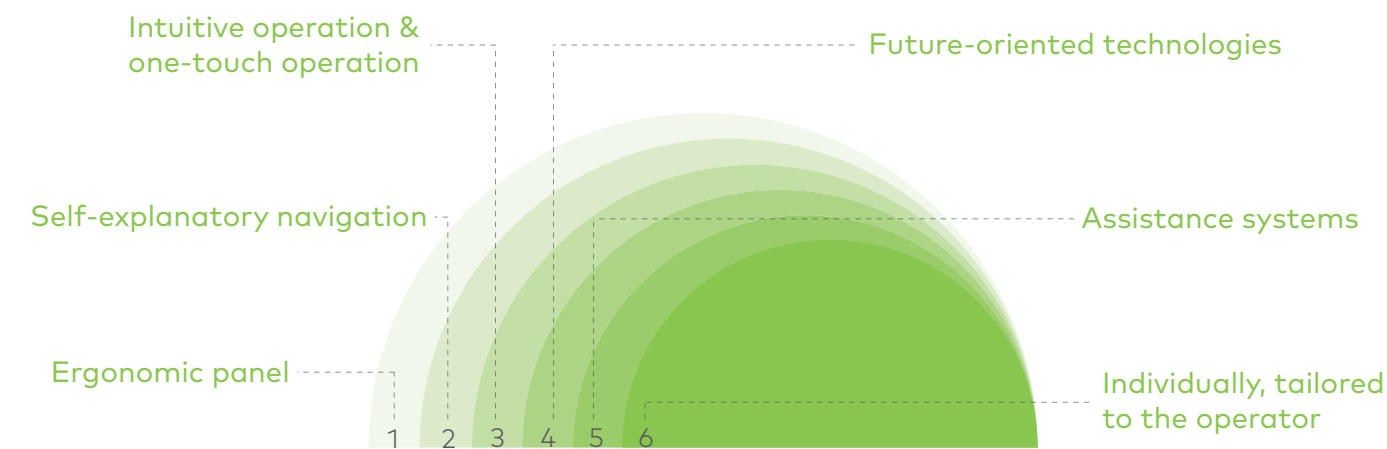

Smart Functions

iQ weight control*

Constant filling under changing conditions

Mold parallelism measurement

Mold parallelism measurement and clamping force optimization

Mold protection*

Precision monitoring during the whole injection molding process

ecograph

Display of energy consumption for last and current cycle.

ecobalance*

Intercept of power peaks and uniform distribution of the total energy demand across the cycle.

Micrograph

Recording process parameters for quality control purposes that helps you analyze, optimize and monitor the process.

Autoprotect injection monitoring*

Self-learning system for highly sensitive mold protection during injection.

Program parameter limits*

Specifying the input range for up to 150 parameters individually to prevent setting of illogical or severely deviating.

e-help

Information on the most important functions and operations of a system directly at the machine.

For more options, please contact regional sales.
*Optional functions

Injection Unit	1510	2410	3510	5210	8210	11610	16610	22010	43210	56910
Screw Diameter mm	55 60 70	60 70 80	70 80 90	80 90 105	90 105 120	105 120 135	120 135 150	135 150 160 170	170 190 200	190 210 220
t-win 4500 PRO										
t-win 6500 PRO										
t-win 7500 PRO										
t-win 9000 PRO										
t-win 10500 PRO										
t-win 14000 PRO										
t-win 16000 PRO										
t-win 18000 PRO										
t-win 21000 PRO										
t-win 24000 PRO										
t-win 27000 PRO										
t-win 32000 PRO										
t-win 40000 PRO										

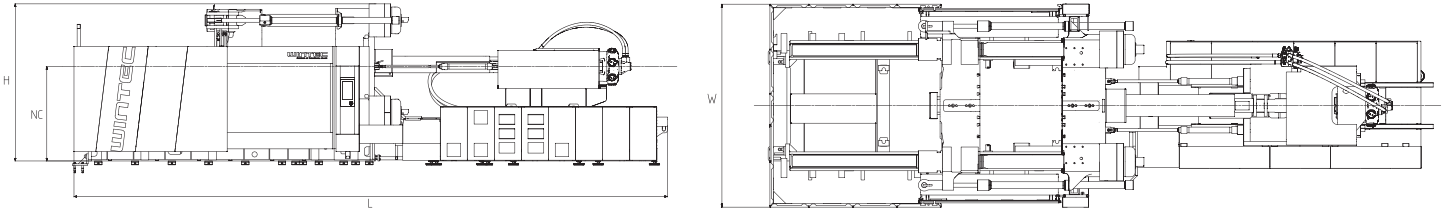

Memo